

Indoor Unit Overview

The indoor unit and its display may look slightly different from the illustration shown below, depending on the model and the panel type.

SLIM DUCT TYPE

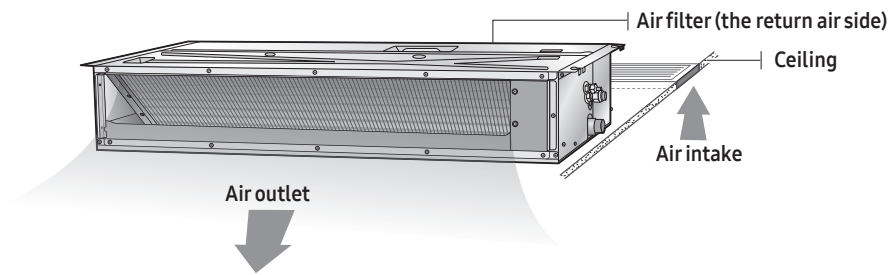

HOME DUCT TYPE

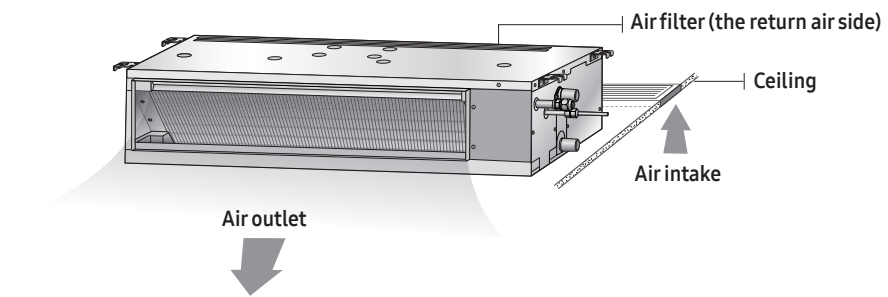

GLOBAL DUCT TYPE

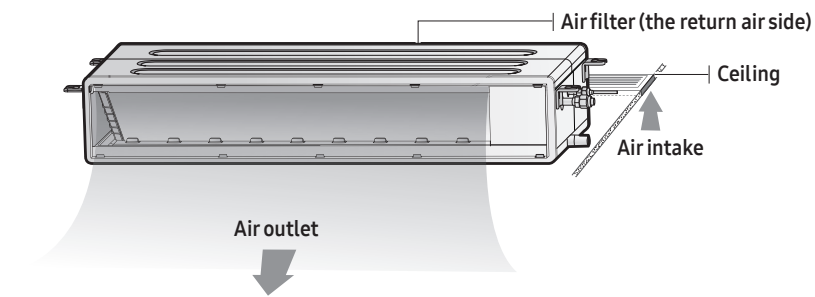

Operation Features

Operating temperature and humidity

Model	Mode	Outdoor temperature	Indoor temperature	Indoor humidity
AC026RN*DKG	Cool mode	-15°C to 46°C	18°C to 32°C	80% or less
AC035RN*DKG	Heat mode	-20°C to 24°C	30°C or less	-
AC026BN*DKG				
AC035BN*DKG	Dry mode	-15°C to 46°C	18°C to 32°C	80% or less
AC052RN*DKG	Cool mode	-15°C to 50°C	18°C to 32°C	80% or less
AC071RN*DKG	Heat mode	-20°C to 24°C	30°C or less	-
AC052BN*DKG				
AC071BN*DKG	Dry mode	-15°C to 50°C	18°C to 32°C	80% or less
AC100RN*DKG				
AC120RN*DKG				
AC140RN*DKG				

CAUTION

- If you use the air conditioner at a relative humidity above 80%, it may cause a formation of condensation and a leakage of water on the floor.
- The rated heating capacity is based on an outdoor temperature of 7°C. If the outdoor temperature goes down below 0°C, heating efficiencies may decrease depending on the temperature conditions.
- If the indoor unit is out of the operating temperature and humidity range, the safety device may operate and the air conditioner may stops.
- If the indoor unit is installed in an IT room (for example, computer room), a separate back-up system must be installed, and the reliability of our product cannot be guaranteed at temperatures outside the operating temperature range.

Cleaning and Maintaining

Cleaning the air filter

For optimal performance clean the filter periodically. For your safety, when cleaning the filter make sure the unit is off.

When cleaning the filter, make sure to unplug the power from the unit. Washable foam based Air filter captures large particles from the air. The filter is cleaned with a vacuum or by hand washing.

SLIM DUCT TYPE

1. Slide out the Air filter on the rear side panel to the right side.

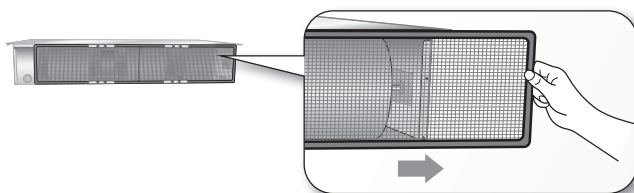

2. Clean the Air filter with a vacuum cleaner or soft brush. If dust is too heavy, then rinse it with running water and dry it in a ventilated area.

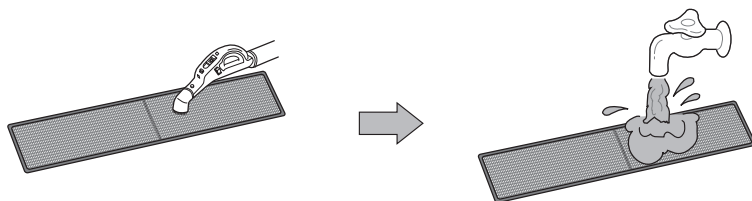

- For best conditions, repeat every two weeks.
- If the Air filter dries in a confined (or humid) area, odors may generate. If it occurs, re-clean and dry it in a ventilated area.

3. Insert the Air filter back in its original position.

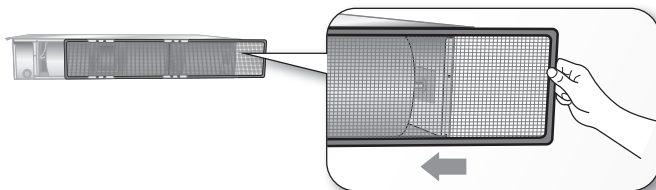

Cleaning and Maintaining

HOME DUCT TYPE

1. Pull out the Air filter from the frame.

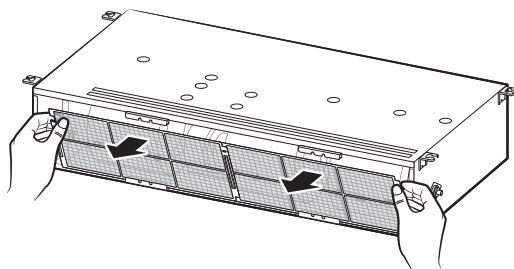

2. Clean the Air filter with a vacuum cleaner or soft brush. If dust is too heavy, then rinse it with running water and dry it in a ventilated area.

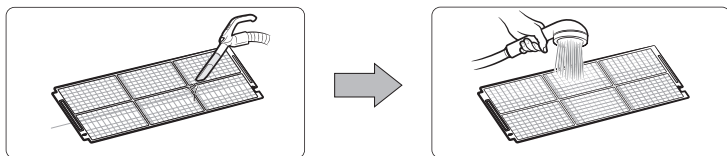

- For best conditions, repeat every two weeks.
- If the Air filter dries in a confined (or humid) area, odors may generate. If it occurs, re-clean and dry it in a ventilated area.

3. Insert the Air filter back in its original position.

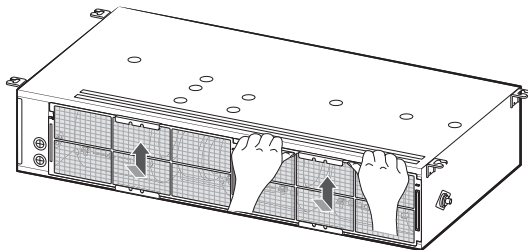

GLOBAL DUCT TYPE

1. Grab the handle on the top of the filter, then go down and remove the filter from the indoor unit.

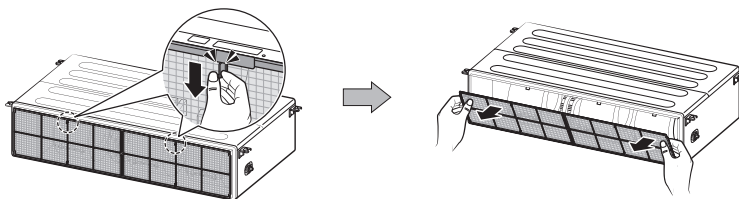

2. Clean the Air filter with a vacuum cleaner or soft brush. If dust is too heavy, then rinse it with running water and dry it in a ventilated area.

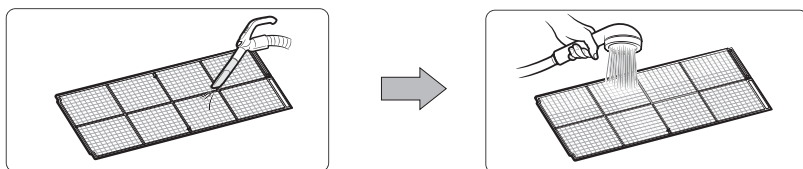

- For best conditions, repeat every two weeks.
- If the Air filter dries in a confined (or humid) area, odors may generate. If it occurs, re-clean and dry it in a ventilated area.

3. Insert the Air filter back in its original position.

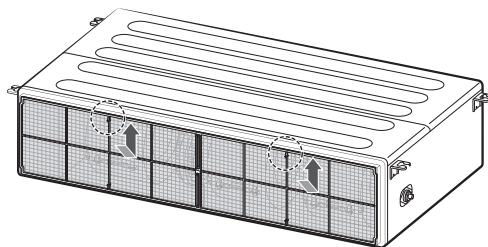

NOTE

- The illustration shown above may differ from yours depending on your model.
- After cleaning the filter, press the **Filter Reset** button on the remote control for 2 seconds to reset the filter schedule. Filter sign indicator will be on for cleaning time.

Cleaning and Maintaining

Periodical maintenance

- If the air conditioner will not be used for an extended period of time, dry the air conditioner to maintain in best conditions.
1. Dry the air conditioner thoroughly by operating in Fan mode for 3 to 4 hours and disconnect the power plug. There may be internal damage if moisture is left in components.
 2. Before using the air conditioner again, dry the inner components of the air conditioner again by running in Fan mode for 3 to 4 hours. This helps remove odours that may have generated from dampness.

Periodical checks

Refer to the following chart to maintain the air conditioner properly.

Type	Description	Monthly	Every 4 months	Once a year
Indoor unit	Clean the air filter (1).	●		
	Clean the condensate drain pan (2).			●
	Thoroughly clean the heat exchanger (2).			●
	Clean the condensate drain pipe (2).		●	
	Replace the remote control batteries (1).			●
Outdoor unit	Clean the heat exchanger on the outside of the unit (2).		●	
	Clean the heat exchanger on the inside of the unit (2).			●
	Clean the electric components with jets of air (2).			●
	Verify that all the electric components are firmly tightened (2).			●
	Clean the fan (2).			●
	Verify that all the fan assembly is firmly tightened (2).			●
	Clean the condensate drain pan (2).			●

NOTE

- The checks and maintenance operations described above are essential to guarantee the efficiency of the air conditioner. The frequency of these operations may vary depending on the characteristics of the area, the amount of dust, etc.
 - a. The above mentioned operations should be performed more frequently if the area of installation is very dusty.
 - b. These operations must always be performed by qualified personnel. For more detailed information, refer to Installation Manual.