

Hot Water Fittings

| Removable tube bundle exchanger for water (standard and curved) complete with a pair of seals, insulated bushings and bolts | | | | | | | | | |
|--|-----|------|-----|---|---|--|---|------------------------|---|
| Sq.m. | Ø | H | P | AISI316L Stainless Steel on Inox plate | | AISI304 Stainless Steel on teflon plate | | Copper on teflon plate | |
| | | | | Code | € | Code | € | Code | € |
| 0.50 | 290 | 445 | 190 | FTII 05 | - | FTIT 05 | - | FTRT 05 | - |
| | | 460 | | FTII 05/C | - | FTIT 05/C | - | FTRT 05/C | - |
| 0.75 | 290 | 495 | 190 | FTII 07 | - | FTIT 07 | - | FTRT 07 | - |
| | | 460 | | FTII 07/C | - | FTIT 07/C | - | FTRT 07/C | - |
| 1.00 | 290 | 555 | 255 | FTII 10 | - | FTIT 10 | - | FTRT 10 | - |
| | | 500 | | FTII 10/C | - | FTIT 10/C | - | FTRT 10/C | - |
| 1.50 | 380 | 600 | 355 | FTII 15 | - | FTIT 15 | - | FTRT 15 | - |
| | | 500 | | FTII 15/C | - | FTIT 15/C | - | FTRT 15/C | - |
| 2.00 | 380 | 600 | 355 | FTII 20 | - | FTIT 20 | - | FTRT 20 | - |
| | | 500 | | FTII 20/C | - | FTIT 20/C | - | FTRT 20/C | - |
| 3.00 | 380 | 720 | 430 | FTII 30 | - | FTIT 30 | - | FTRT 30 | - |
| | | 595 | | FTII 30/C | - | FTIT 30/C | - | FTRT 30/C | - |
| 4.00 | 430 | 750 | 430 | FTII 40 | - | FTIT 40 | - | FTRT 40 | - |
| | | 625 | | FTII 40/C | - | FTIT 40/C | - | FTRT 40/C | - |
| 5.00 | 430 | 780 | 445 | FTII 50 | - | FTIT 50 | - | FTRT 50 | - |
| | | 750 | | FTII 50/C | - | FTIT 50/C | - | FTRT 50/C | - |
| 8.00 | 430 | 1250 | 465 | FTII 80 | - | FTIT 80 | - | FTRT 80 | - |
| | | 1340 | | FTII 80/C | - | FTIT 80/C | - | FTRT 80/C | - |
| 10.00 | 430 | 1510 | 550 | FTII 100 | - | FTIT 100 | - | FTRT 100 | - |
| | | 1540 | | FTII 100/C | - | FTIT 100/C | - | FTRT 100/C | - |

| | | | | | | | | | |
|-------|-----|------|-----|---|---|--------------|---|--------------|---|
| 3.00 | 480 | 595 | 430 | - | - | FTIT 4 30/C | - | FTRT 4 30/C | - |
| 4.00 | 480 | 625 | 430 | - | - | FTIT 4 40/C | - | FTRT 4 40/C | - |
| 5.00 | 480 | 750 | 445 | - | - | FTIT 4 50/C | - | FTRT 4 50/C | - |
| 8.00 | 480 | 1340 | 465 | - | - | FTIT 4 80/C | - | FTRT 4 80/C | - |
| 10.00 | 480 | 1540 | 550 | - | - | FTIT 4 100/C | - | FTRT 4 100/C | - |

The curved-down tube bundle against bacterial growth is identified with the extension "/C", compared to the code of the standard version.

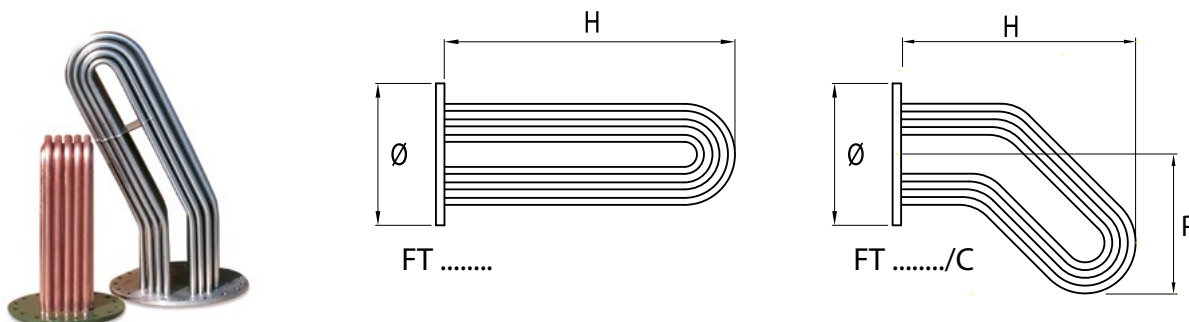

| Removable curved tube bundle exchanger complete with PED certification for steam at 6 bar, complete with transmission headstock pair of seals, insulated bushings and bolts | | | | |
|--|-----|-----|--|---|
| Sq.m. | Ø | H | AISI316L Stainless Steel on Inox plate | |
| | | | Code | € |
| 0.50 | 290 | 445 | 6 FTII 05 | - |
| 0.75 | 290 | 495 | 6 FTII 07 | - |
| 1.00 | 290 | 555 | 6 FTII 10 | - |
| 1.50 | 380 | 600 | 6 FTII 15 | - |
| 2.00 | 380 | 600 | 6 FTII 20 | - |
| 3.00 | 380 | 720 | 6 FTII 33 | - |
| 3.00 | 430 | 720 | 6 FTII 34 | - |
| 4.00 | 430 | 750 | 6 FTII 40 | - |
| 5.00 | 430 | 780 | 6 FTII 50 | - |
| 3.00 | 480 | 720 | 6 FTII 38 | - |
| 4.00 | 480 | 750 | 6 FTII 48 | - |
| 5.00 | 480 | 780 | 6 FTII 58 | - |

| Removable curved tube bundle exchanger complete with PED certification for steam at 12 bar, complete with transmission headstock pair of seals, insulated bushings and bolts | | | | |
|---|-----|-----|---|---|
| Sq.m. | Ø | H | AISI 316L Stainless Steel on Inox plate | |
| | | | Code | € |
| 0.50 | 290 | 490 | 12 FTII 05 | - |
| 0.75 | 290 | 445 | 12 FTII 07 | - |
| 1.00 | 290 | 530 | 12 FTII 10 | - |
| 1.50 | 380 | 600 | 12 FTII 15 | - |
| 2.00 | 380 | 600 | 12 FTII 20 | - |
| 3.00 | 380 | 720 | 12 FTII 33 | - |
| 3.00 | 430 | 720 | 12 FTII 34 | - |
| 4.00 | 430 | 750 | 12 FTII 40 | - |
| 5.00 | 430 | 780 | 12 FTII 50 | - |
| 3.00 | 480 | 720 | 12 FTII 38 | - |
| 4.00 | 480 | 750 | 12 FTII 48 | - |
| 5.00 | 480 | 780 | 12 FTII 58 | - |

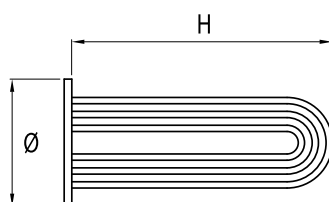

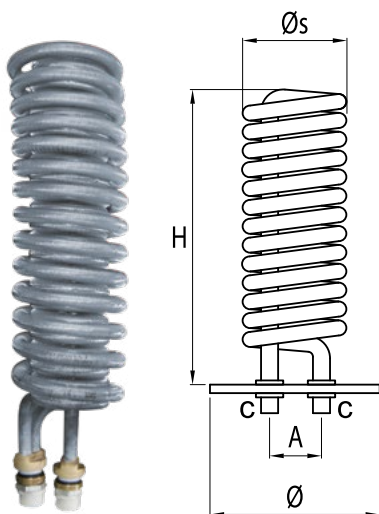

| Tinned finned copper exchanger for water, complete with blanking plate, gasket and bolts | | | | | | | |
|--|-----|------|-----|----------------|----|--------------------|---|
| Sq.m. | Ø | H | Øs | C | A | on enamelled plate | |
| | | | | | | Code | € |
| 0.76 | 290 | 400 | 145 | 3/4" ext. thr. | 70 | SRA 07 | - |
| 0,94 | 290 | 400 | 145 | 3/4" ext. thr. | 70 | SRA 09/2 | - |
| 0,94 | 380 | 400 | 145 | 3/4" ext. thr. | 70 | SRA 09/3 | - |
| 1.58 | 290 | 460 | 170 | 3/4" ext. thr. | 70 | SRA 15/2 | - |
| 1.58 | 380 | 460 | 170 | 3/4" ext. thr. | 70 | SRA 15/3 | - |
| 2.63 | 380 | 610 | 190 | 3/4" ext. thr. | 70 | SRA 26 | - |
| 3.17 | 380 | 680 | 190 | 3/4" ext. thr. | 70 | SRA 31/3 | - |
| 3.17 | 430 | 680 | 190 | 3/4" ext. thr. | 70 | SRA 31/4 | - |
| 4.54 | 380 | 800 | 190 | 1" ext. thr. | 90 | SRA 45/3 | - |
| 4.54 | 430 | 800 | 190 | 1" ext. thr. | 90 | SRA 45/4 | - |
| 5.26 | 430 | 910 | 190 | 1" ext. thr. | 90 | SRA 52/4 | - |
| 5.26 | 480 | 910 | 190 | 1" ext. thr. | 90 | SRA 52/5 | - |
| 6.34 | 430 | 1070 | 190 | 1" ext. thr. | 90 | SRA 63/4 | - |
| 6.34 | 480 | 1070 | 190 | 1" ext. thr. | 90 | SRA 63/5 | - |

Caution: in the order phase, check the diameter of the blanking plate on which the heat exchanger is mounted.

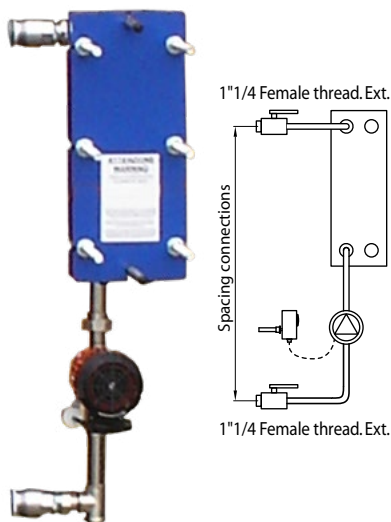

| Exchange kit in AISI 316L stainless steel plate consisting of: exchanger, SHW pump, thermostat and connection fittings | | | | | | | |
|--|-----------------------------|----------------------|-------|---|------------------|---------|---|
| Exchange power * | SHW continuous production * | Inspection exchanger | | | Brazen exchanger | | |
| | | Exchanger module | Code | € | Exchanger module | Code | € |
| 35 (30000) | 860 | (T4A-6NO-8) | K 35 | - | (LA06-16) | K 35 S | - |
| 70 (60000) | 1720 | (T4A-6NO-12) | K 70 | - | (LA06-36) | K 70 S | - |
| 116 (100000) | 2850 | (T4A-6NO-20) | K 116 | - | (LB12-36) | K 116 S | - |
| 151 (130000) | 3710 | (T4A-6NO-26) | K 151 | - | (LB12-50) | K 151 S | - |
| 200 (160000) | 4914 | (T4A-6NO-36) | K 200 | - | (LB12-60) | K 200 S | - |

* Values calculated with the following operating temperatures: 60-80° C Boiler - Sanitary 10-45° C. Additional technical data for the exchange kit associated with a thermal storage for SHW are available on pag. 48.
Caution: When ordering, specify the code of the boiler which is connected kit exchange.

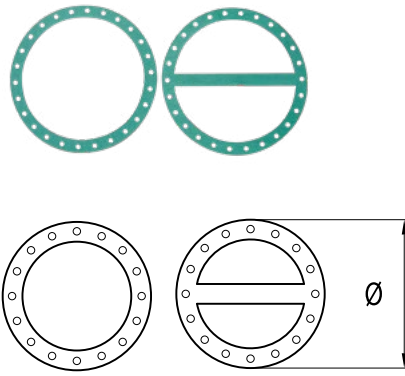

| Pair of seals for removable alimentary WS3815 exchanger complete with insulated bushings and bolts | | | | | |
|--|-----------------|---------------------------|---|---------------------------|---|
| Ø | Number of holes | asbestos-free - for water | | asbestos-free - for steam | |
| | | Code | € | Code | € |
| 290 | 12 | CGNA 29 | - | CGNV 29 | - |
| 380 | 19 | CGNA 38 | - | CGNV 38 | - |
| 430 | 22 | CGNA 43 | - | CGNV 43 | - |
| 480 | 26 | CGNA 48 | - | CGNV 48 | - |

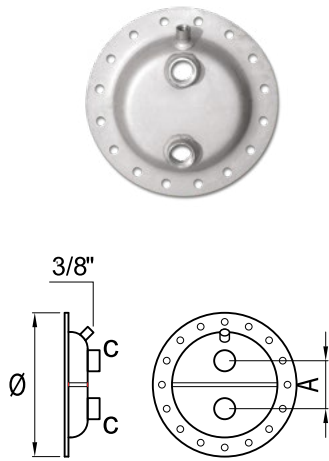

| Sendback module for extractable exchangers | | | | | | | |
|--|-----|----|-----------------|-----------|---|------------|---|
| Ø | A | C | Number of holes | for water | | | |
| | | | | Inox | | galvanized | |
| | | | | Code | € | Code | € |
| 290 | 115 | 1" | 12 | TRI 29 | - | TRZ 29 | - |
| 380 | 145 | 2" | 19 | TRI 38 | - | TRZ 38 | - |
| 430 | 195 | 2" | 22 | TRI 43 | - | TRZ 43 | - |
| 480 | 195 | 2" | 26 | TRI 48 | - | TRV 48 | - |

The sendback module Ø 480 is painted instead of galvanized (TRV48)

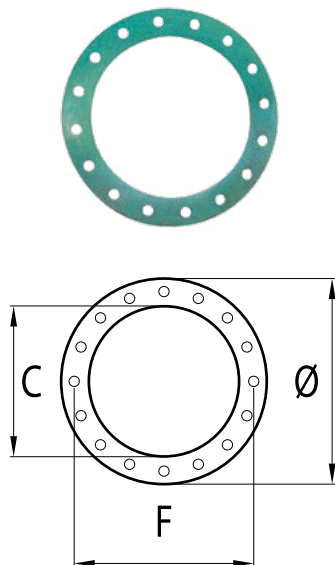

| Seal for inspection hatches | | | | | | | |
|-----------------------------|-----|-----|---------|-------|---|---------------------------|---|
| Ø | C | F | Hole | EPDM | | asbestos-free - for water | |
| | | | | Code | € | Code | € |
| 180 | 120 | 150 | 8 Ø 13 | GG 18 | - | GNA 18 | - |
| 240 | 170 | 210 | 12 Ø 13 | - | - | GNA 24 | - |
| 290 | 200 | 260 | 12 Ø 13 | GG 29 | - | GNA 29 | - |
| 380 | 300 | 345 | 19 Ø 13 | - | - | GNA 38 | - |
| 430 | 350 | 396 | 22 Ø 14 | - | - | GNA 43 | - |
| 480 | 400 | 444 | 26 Ø 14 | - | - | GNA 48 | - |
| 620 | 520 | 568 | 24 Ø 18 | - | - | GNA 62 | - |

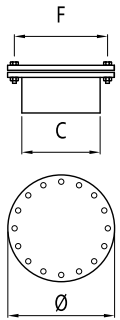

| Inspection hatch with gasket and bolts | | | | | | | |
|--|-----|-----|----------|----------------|---|-----------|---|
| Ø | C | F | Hole | AISI 316L Inox | | Painted | |
| | | | | Code | € | Code | € |
| 180 | 120 | 150 | 8 M10/12 | BCP 18 X | - | BCP 18 VN | - |
| 240 | 170 | 210 | 12 M12 | BCP 24 X | - | BCP 24 VN | - |
| 290 | 200 | 260 | 12 M12 | BCP 29 X | - | BCP 29 VN | - |
| 380 | 300 | 344 | 19 Ø14 | BCP 38 X | - | BCP 38 VN | - |
| 430 | 350 | 396 | 22 Ø14 | BCP 43 X | - | BCP 43 VN | - |
| 480 | 400 | 444 | 26 Ø14 | BCP 48 X | - | BCP 48 VN | - |
| 620 | 520 | 568 | 24 Ø18 | BCP 62 X | - | BCP 62 VN | - |

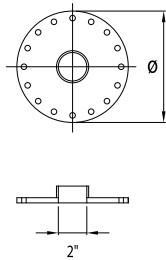

| Flange with adapter for electrical resistance | | | | | | | |
|---|-------------|----------------|---|-----------|---|-----------|---|
| Ø | N° of Holes | AISI 316L Inox | | enamelled | | Keramtech | |
| | | Code | € | Code | € | Code | € |
| 180 | 8 | CRI 180 | - | CRV 180 | - | - | - |
| 290 | 12 | CRI 290 | - | CRV 290 | - | - | - |
| 380 | 19 | CRI 380 | - | CRV 380 | - | CRK 380 | - |
| 430 | 22 | CRI 430 | - | CRV 430 | - | CRK 430 | - |
| 480 | 26 | - | - | - | - | CRK 480 | - |

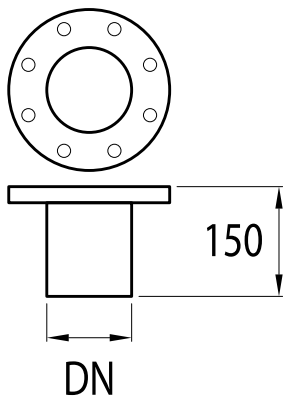

| Flanged connections UNI EN 1092-1 (ex UNI 2278) | | | | | | |
|---|----------------|---|------------|---|----------|---|
| DN | AISI 316L Inox | | Galvanized | | Painted | |
| | Code | € | Code | € | Code | € |
| 32 | DN 32 X | - | DN 32 Z | - | DN 32 V | - |
| 40 | DN 40 X | - | DN 40 Z | - | DN 40 V | - |
| 50 | DN 50 X | - | DN 50 Z | - | DN 50 V | - |
| 65 | DN 65 X | - | DN 65 Z | - | DN 65 V | - |
| 80 | DN 80 X | - | DN 80 Z | - | DN 80 V | - |
| 100 | DN 100 X | - | DN 100 Z | - | DN 100 V | - |
| 125 | DN 125 X | - | DN 125 Z | - | DN 125 V | - |
| 150 | DN 150 X | - | DN 150 Z | - | DN 150 V | - |
| 200 | DN 200 X | - | DN 200 Z | - | DN 200 V | - |
| 250 | DN 250 X | - | DN 250 Z | - | DN 250 V | - |
| 300 | DN 300 X | - | DN 300 Z | - | DN 300 V | - |

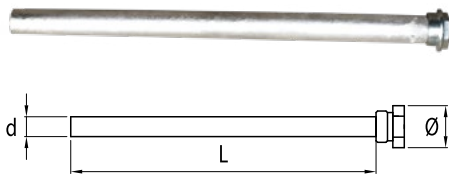

| Magnesium sacrificial anode | | | | | |
|-----------------------------|--------|--------|----------------------|-------|---|
| Ø | L (mm) | d (mm) | Boiler Capacity (Lt) | Code | € |
| 1"1/4 | 400 | 22 | 100 - 800 | AM 22 | - |
| 1"1/4 | 500 | 32 | 1000 - 5000 | AM 32 | - |

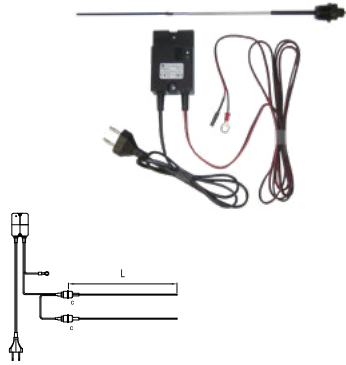

| Electronic anode with impressed current | | | | | |
|---|---------------|------|-----|----------------------|---|
| Code | Electrodes N° | c | L | Boiler Capacity (Lt) | € |
| EPS 375/125/1 | 1 | 1/2" | 375 | 150 - 1000 | - |
| EPS 375/125/2 | 2 | 1/2" | 375 | 1500 - 2000 | - |
| EPS 700/200/2 | 2 | 1/2" | 700 | 2500 - 5000 | - |



| Recirculation kit for sanitary combined thermal accumulator Maxiwarm - Solarmax - Biomax - Smartwarm | |
|---|---|
| Code | € |
| RCR | - |

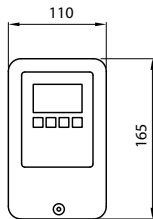

| Electronic control unit for boilers complete with n. 3 probes | |
|---|---|
| Code | € |
| CGB | - |

- Intuitive graphical menu in four languages choice
- Choice of 8 possible configurations hydraulic
- Control of the temperature differential on the solar circuit
- Control of solar pump: PWM, 0-10V, asynchronous
- Temperature control on the boiler (2 sensors) and panel (1 probe)
- Free contact to activate the intervention of a boiler or integration of an electrical resistance (230VAC - 13A max - max 2.5 kW)
- Cycle Management antilegionella with solar heater or integration
- Optional management of sanitary recirculation with the ability to connect an additional probe

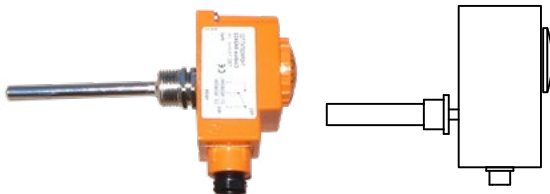

| Thermostat for hot water with cockpit 1/2" L = 100mm | |
|--|---|
| Code | € |
| TSC | - |

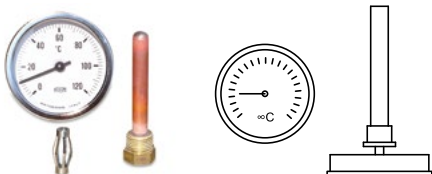

| Thermometer for hot water with cockpit 1/2" L = 100mm | |
|---|---|
| Code | € |
| TMC | - |

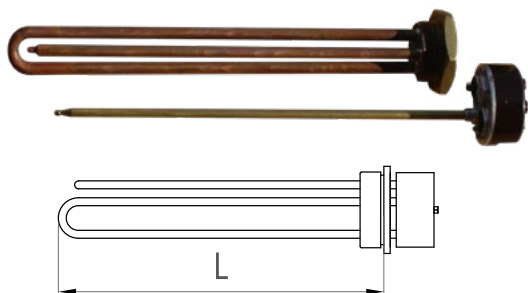

| Copper electrical resistance for water connection 1 "1/4 - IP 20 - 230V - with thermostat | | | |
|--|--------|--------|---|
| Power (w) | L (mm) | Code | € |
| 1500 | 300 | RER 15 | - |
| 2000 | 300 | RER 20 | - |
| 3000 | 400 | RER 30 | - |

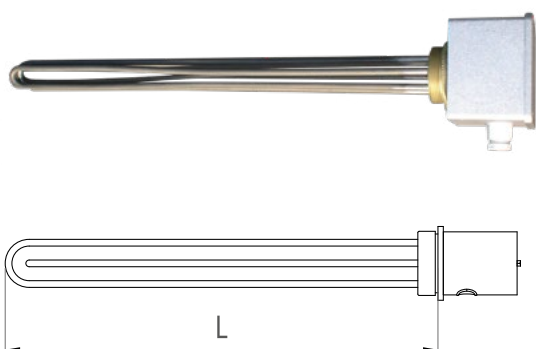

| Stainless steel electrical resistance for water connection 1 "1/2 - IP 65 range thermostat 30/70 ° C and safety thermostat | | | | |
|--|--------|-----------|-----------|---|
| Power (w) | L (mm) | Supply | Code | € |
| 3000 | 320 | ~ 230 V | REX 30 M | - |
| 3000 | 350 | 3 ~ 400 V | REX 30 T | - |
| 4000 | 400 | 3 ~ 400 V | REX 40 T | - |
| 5000 | 500 | 3 ~ 400 V | REX 50 T | - |
| 7500 | 700 | 3 ~ 400 V | REX 75 T | - |
| 9000 | 700 | 3 ~ 400 V | REX 90 T | - |
| 12000 | 850 | 3 ~ 400 V | REX 120 T | - |

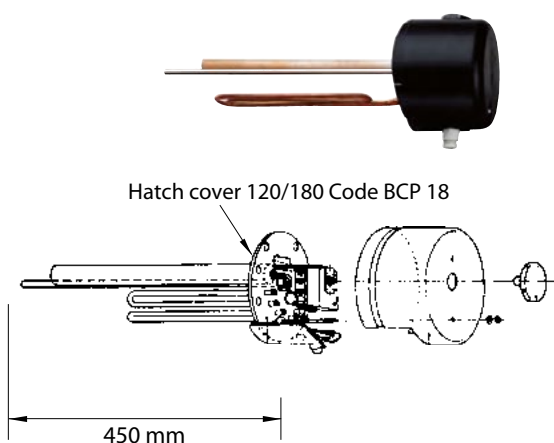

| Copper electrical resistance for water flange 120/180 complete with seal and magnesium anode - IP 44 range thermostat 15/85 ° C and safety thermostat | | | |
|---|-----------|---------|---|
| Power (w) | Supply | Code | € |
| 1700 | ~ 230 V | R18-17M | - |
| 2000 | ~ 230 V | R18-20M | - |
| 2500 | ~ 230 V | R18-25M | - |
| 2500 | 3 ~ 400 V | R18-25T | - |
| 3000 | 3 ~ 400 V | R18-30T | - |
| 3300 | ~ 230 V | R18-33M | - |
| 3800 | 3 ~ 400 V | R18-38T | - |
| 5000 | 3 ~ 400 V | R18-50T | - |
| 6000 | 3 ~ 400 V | R18-60T | - |
| 7500 | 3 ~ 400 V | R18-75T | - |
| 9900 | 3 ~ 400 V | R18-99T | - |

Thermal insulations

The TML for years specialized in the production of boiler (containers of thermal energy), has always given proper attention to the degree of insulation of its products, aware that insulate means limiting energy needs.

It offers customers a wide range of technical solutions that meet all the energy requirements of the law.

Upon request, the TML is able to realize also insulations with high characteristics of resistance to fire (class 0 in Italy, Class M0 in France, Class A1 in Germany, etc.).

The TML also operates OEM being able to customize colors, accessories, displays and packaging according to the most demanding customer requirements.

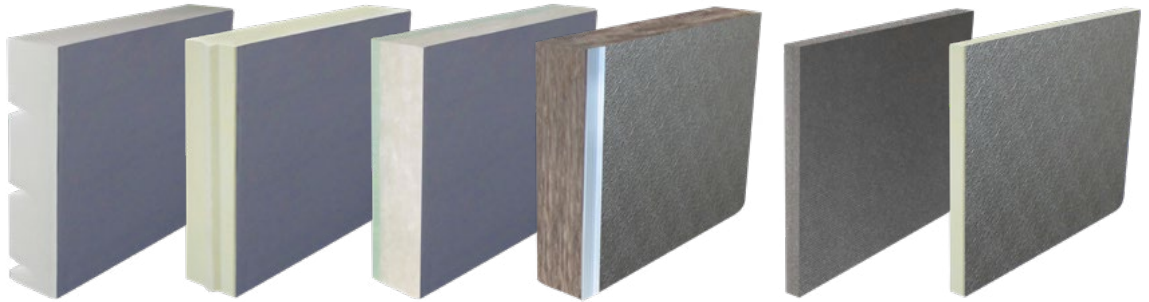

| Type of insulation | Heating | | | |
|-------------------------------|----------------------------|------------------------|----------------------|--------------------|
| | Flexible polyurethane | Rigid polyurethane | Polyester | Mineral fiber |
| External coating | PVC ABS - | PVC ABS Aluminum | PVC ABS - | - - Aluminum |
| Thickness (mm) | 50 - 100 - 130 - 160 - 200 | 50 - 70 - 100 | 50 - 100 - 125 - 150 | 50 - 100 |
| Accumulation capacity (Lt) | 100 ÷ 15000 | 100 ÷ 2000 | 100 ÷ 5000 | 100 ÷ 5000 |
| Density (Kg/m ³) | 15 ÷ 17,5 | 40 ÷ 45 | 11 ÷ 25 | 11 ÷ 25 |
| Thermal conductivity λ (W/mK) | 0,041 ÷ 0,044 | 0,023 ÷ 0,026 | 0,036 ÷ 0,044 | 0,037 ÷ 0,041 |

| Refrigeration | |
|--------------------------|---------------------------------------|
| Reticulated polyethylene | Rigid polyurethane (direct injection) |
| PVC - | PVC ABS |
| Aluminum | Aluminum |
| 20 - 40 | 25 - 50 |
| 100 ÷ 15000 | 100 ÷ 800 |
| 29 ÷ 31 | 40 ÷ 45 |
| 0,034 ÷ 0,037 | 0,023 ÷ 0,026 |

The above figures are approximate.

For special insulations, require prior approval

